

Pulegge Dentate Passo Pollici

Imperial Pitch Timing Pulleys

L

Passo 9,525mm / 3/5" Pitch

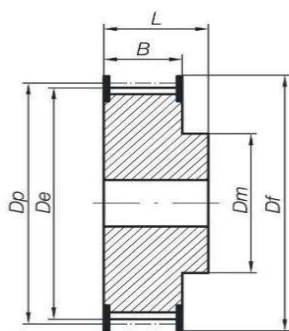

6F

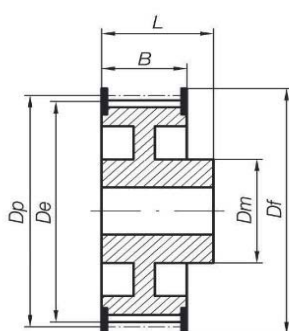

6WF

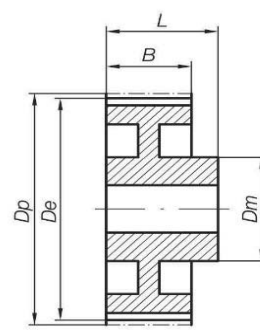

6W

Materiale: Acciaio

Material: Steel

Codice Code	Disegno Drawing	N° Denti Teeth	Dp	De	Df	Dm	B	L
10 L 050 F	6F	10	30,32	29,56	37,0	20	19	28
11 L 050 F	6F	11	33,35	32,59	37,0	22	19	30
12 L 050 F	6F	12	36,38	35,62	43,0	24	19	30
13 L 050 F	6F	13	39,41	38,65	44,0	28	19	30
14 L 050 F	6F	14	42,45	41,69	48,0	28	19	30
15 L 050 F	6F	15	45,48	44,72	51,0	34	19	30
16 L 050 F	6F	16	48,51	47,75	54,0	36	19	32
17 L 050 F	6F	17	51,54	50,78	57,0	36	19	32
18 L 050 F	6F	18	54,57	53,81	60,0	40	19	32
19 L 050 F	6F	19	57,61	56,85	64,0	40	19	32
20 L 050 F	6F	20	60,64	59,88	66,5	40	19	32
21 L 050 F	6F	21	63,67	62,91	70,0	45	19	32
22 L 050 F	6F	22	66,70	65,94	75,0	45	19	32
23 L 050 F	6F	23	69,73	68,97	79,0	55	19	32
24 L 050 F	6F	24	72,77	72,01	79,0	55	19	32
25 L 050 F	6F	25	75,80	75,04	82,5	58	19	32
26 L 050 F	6F	26	78,83	78,07	86,0	58	19	32
27 L 050 F	6F	27	81,86	81,10	86,0	58	19	32
28 L 050 F	6F	28	84,89	84,13	91,0	58	19	32
29 L 050 F	6F	29	87,93	87,17	94,0	58	19	32
30 L 050 F	6F	30	90,96	90,20	97,0	70	19	32
32 L 050 F	6F	32	97,02	96,26	102,0	70	19	32
33 L 050 F	6F	33	100,05	99,29	106,0	70	19	32
34 L 050 F	6F	34	103,08	102,32	112,0	70	19	32
35 L 050 F	6F	35	106,12	105,36	112,0	70	19	32
36 L 050 F	6F	36	109,15	108,39	115,0	70	19	32
40 L 050 F	6WF	40	121,28	120,52	128,0	70	19	32
41 L 050 F	6WF	41	124,31	123,55	135,0	70	19	32
42 L 050 F	6WF	42	127,34	126,58	135,0	70	19	32
44 L 050 F	6WF	44	133,40	132,64	142,0	70	19	32
45 L 050 F	6WF	45	136,44	135,68	142,0	70	19	32
47 L 050 F	6WF	47	142,50	141,74	150,0	70	19	32
48 L 050 F	6WF	48	145,53	144,76	150,0	70	19	32
50 L 050	6W	50	151,60	150,84	-	70	19	32
52 L 050	6W	52	157,66	156,90	-	70	19	32
56 L 050	6W	56	169,79	169,03	-	70	19	32
57 L 050	6W	57	172,82	172,06	-	70	19	32

L 050 (passo 3/5" - 9,525 mm) per cinghia di larghezza 0,50" - 12,7 mm
L 050 (3/5" pitch - 9,525 mm) for 0,50" - 12,7 mm width belt

L

Passo 9,525mm / 3/5" Pitch

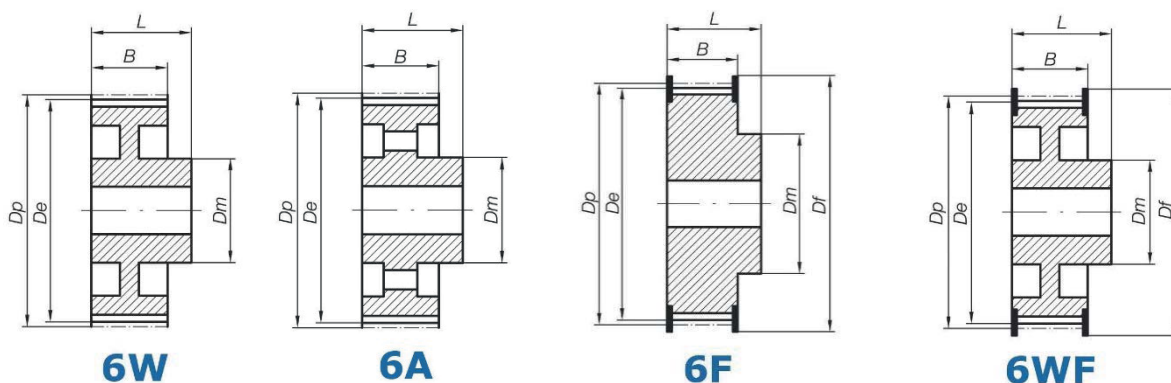

Materiale: Acciaio

Material: Steel

	Codice Code	Disegno Drawing	N° Denti Teeth	Dp	De	Df	Dm	B	L
	60 L 050	6W	60	181,91	181,15	-	75	19	42
	72 L 050	6A	72	218,30	217,54	-	75	19	42
	84 L 050	6A	84	254,68	253,92	-	75	19	42
	90 L 050	6A	90	272,87	272,11	-	75	19	42
L 075 (passo 3/5" - 9,525 mm) per cinghia di larghezza 0,75" - 19,05 mm L 075 (3/5" pitch - 9,525 mm) for 0,75" - 19,05 mm width belt	10 L 075 F	6F	10	30,32	29,56	37,0	20	25	38
	11 L 075 F	6F	11	33,35	32,59	37,0	22	25	38
	12 L 075 F	6F	12	36,38	35,62	43,0	24	25	38
	13 L 075 F	6F	13	39,41	38,65	44,0	28	25	38
	14 L 075 F	6F	14	42,45	41,69	48,0	28	25	38
	15 L 075 F	6F	15	45,48	44,72	51,0	34	25	38
	16 L 075 F	6F	16	48,51	47,75	54,0	36	25	38
	17 L 075 F	6F	17	51,54	50,78	57,0	36	25	38
	18 L 075 F	6F	18	54,57	53,81	60,0	40	25	38
	19 L 075 F	6F	19	57,61	56,85	64,0	40	25	38
	20 L 075 F	6F	20	60,64	59,88	66,5	40	25	38
	21 L 075 F	6F	21	63,67	62,91	70,0	45	25	38
	22 L 075 F	6F	22	66,70	65,94	75,0	45	25	38
	23 L 075 F	6F	23	69,73	68,97	79,0	55	25	38
	24 L 075 F	6F	24	72,77	72,01	79,0	55	25	38
	25 L 075 F	6F	25	75,80	75,04	82,5	58	25	38
	26 L 075 F	6F	26	78,83	78,07	86,0	58	25	38
	27 L 075 F	6F	27	81,86	81,10	86,0	58	25	38
	28 L 075 F	6F	28	84,89	84,13	91,0	58	25	38
	29 L 075 F	6F	29	87,93	87,17	94,0	58	25	38
	30 L 075 F	6F	30	90,96	90,20	97,0	70	25	38
	32 L 075 F	6F	32	97,02	96,26	102,0	70	25	38
	33 L 075 F	6F	33	100,05	99,29	106,0	70	25	38
	34 L 075 F	6F	34	103,08	102,32	112,0	70	25	38
	35 L 075 F	6F	35	106,12	105,36	112,0	70	25	38
	36 L 075 F	6F	36	109,15	108,39	115,0	70	25	38
	40 L 075 F	6WF	40	121,28	120,52	128,0	70	25	38
	41 L 075 F	6WF	41	124,31	123,55	135,0	70	25	38
	42 L 075 F	6WF	42	127,34	126,58	135,0	70	25	38
	44 L 075 F	6WF	44	133,40	132,64	142,0	70	25	38
	45 L 075 F	6WF	45	136,44	135,68	142,0	70	25	38
	47 L 075 F	6WF	47	142,50	141,74	150,0	70	25	38
48 L 075 F	6WF	48	145,53	144,76	150,0	70	25	38	

Pulegge Dentate Passo Pollici

Imperial Pitch Timing Pulleys

L

Passo 9,525mm / 3/5" Pitch

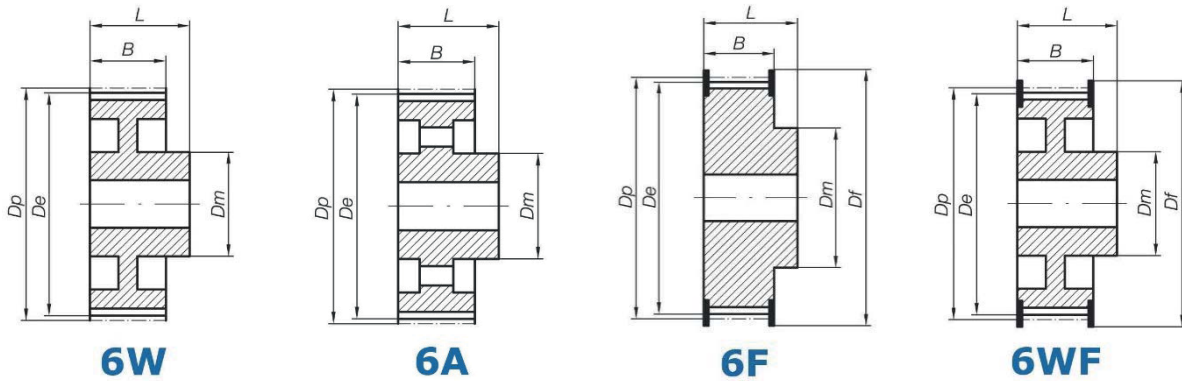

Materiale: Acciaio

Material: Steel

	Codice Code	Disegno Drawing	N° Denti Teeth	Dp	De	Df	Dm	B	L
	50 L 075	6W	50	151,60	150,84	-	70	25	38
	52 L 075	6W	52	157,66	156,90	-	70	25	38
	56 L 075	6W	56	169,79	169,03	-	70	25	38
	57 L 075	6W	57	172,82	172,06	-	70	25	38
	60 L 075	6W	60	181,91	181,15	-	75	25	45
	72 L 075	6A	72	218,30	217,54	-	75	25	45
	84 L 075	6A	84	254,68	253,92	-	75	25	45
	90 L 075	6A	90	272,87	272,11	-	75	25	45
L 100 (passo 3/5" - 9,525 mm) per cinghia di larghezza 1,00" - 25,4 mm L 100 (3/5" pitch - 9,525 mm) for 1,00" - 25,4 mm width belt	10 L 100 F	6F	10	30,32	29,56	37,0	20	32	45
	11 L 100 F	6F	11	33,35	32,59	37,0	22	32	45
	12 L 100 F	6F	12	36,38	35,62	43,0	24	32	45
	13 L 100 F	6F	13	39,41	38,65	44,0	28	32	45
	14 L 100 F	6F	14	42,45	41,69	48,0	28	32	45
	15 L 100 F	6F	15	45,48	44,72	51,0	34	32	45
	16 L 100 F	6F	16	48,51	47,75	54,0	36	32	45
	17 L 100 F	6F	17	51,54	50,78	57,0	36	32	45
	18 L 100 F	6F	18	54,57	53,81	60,0	40	32	45
	19 L 100 F	6F	19	57,61	56,85	64,0	40	32	45
	20 L 100 F	6F	20	60,64	59,88	66,5	40	32	45
	21 L 100 F	6F	21	63,67	62,91	70,0	45	32	45
	22 L 100 F	6F	22	66,70	65,94	75,0	45	32	45
	23 L 100 F	6F	23	69,73	68,97	79,0	55	32	45
	24 L 100 F	6F	24	72,77	72,01	79,0	55	32	45
	25 L 100 F	6F	25	75,80	75,04	82,5	58	32	45
	26 L 100 F	6F	26	78,83	78,07	86,0	58	32	45
	27 L 100 F	6F	27	81,86	81,10	86,0	58	32	45
	28 L 100 F	6F	28	84,89	84,13	91,0	58	32	45
	29 L 100 F	6F	29	87,93	87,17	94,0	58	32	45
	30 L 100 F	6F	30	90,96	90,20	97,0	70	32	45
	32 L 100 F	6F	32	97,02	96,26	102,0	70	32	45
	33 L 100 F	6F	33	100,05	99,29	106,0	70	32	45
	34 L 100 F	6F	34	103,08	102,32	112,0	70	32	45
35 L 100 F	6F	35	106,12	105,36	112,0	70	32	45	
36 L 100 F	6F	36	109,15	108,39	115,0	70	32	45	
40 L 100 F	6WF	40	121,28	120,52	128,0	70	32	45	
41 L 100 F	6WF	41	124,31	123,55	135,0	70	32	45	
42 L 100 F	6WF	42	127,34	126,58	135,0	70	32	45	

L

Passo 9,525mm / 3/5" Pitch

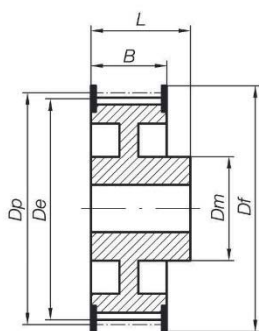

6WF

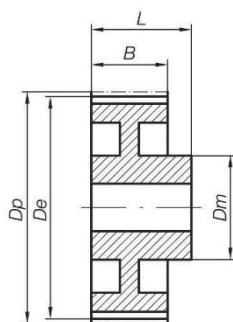

6W

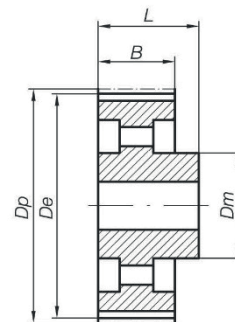

6A

Materiale: Acciaio

Material: Steel

L 100 (passo 9,525 mm) per cinghia da 25,4 mm L 100 (pitch 9,525 mm) for 25,4 mm width belt	Codice Code	Disegno Drawing	N° Denti Teeth	Dp	De	Df	Dm	B	L
	44 L 100 F	6WF	44	133,40	132,64	142,0	70	32	45
	45 L 100 F	6WF	45	136,44	135,68	142,0	70	32	45
	47 L 100 F	6WF	47	142,50	141,74	150,0	70	32	45
	48 L 100 F	6WF	48	145,53	144,76	150,0	70	32	45
	50 L 100	6W	50	151,60	150,84	-	70	32	45
	52 L 100	6W	52	157,66	156,90	-	70	32	45
	56 L 100	6W	56	169,79	169,03	-	70	32	45
	57 L 100	6W	57	172,82	172,06	-	70	32	45
	60 L 100	6W	60	181,91	181,15	-	75	32	50
	72 L 100	6A	72	218,30	217,54	-	75	32	50
	84 L 100	6A	84	254,68	253,92	-	75	32	50
	90 L 100	6A	90	272,87	272,11	-	75	32	50

Df e Dm possono variare senza preavviso | Df and Dm can vary without notice

Nelle forme costruttive gli scarichi di alleggerimento possono leggermente variare | During manufacturing, the lightening relief may vary slightly