

Pulegge Dentate Passo HTD

HTD Pitch Timing Pulleys

HTD 5M

Passo 5mm / 5mm Pitch

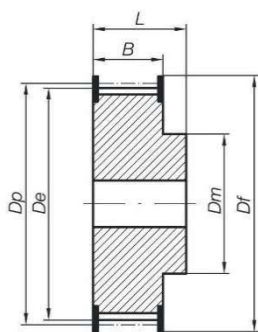

6F

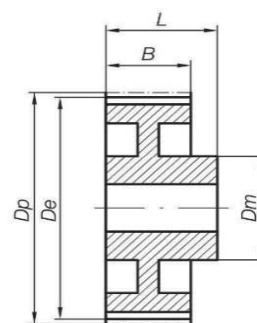

6W

Materiale: Acciaio fino a Z40 e alluminio da Z44 a Z72

Material: Steel up to Z40 and aluminium over Z40

	Codice Code	Disegno Drawing	N° Denti Teeth	Dp	De	Df	Dm	B	L
HTD 5M 09 (passo 5 mm) per cinghia di larghezza 9 mm HTD 5M 09 (5 mm pitch) for 9 mm width belt	12 5M 09 F	6F	12	19,09	17,95	23,0	12	15	20
	14 5M 09 F	6F	14	22,28	21,14	25,0	13	15	20
	15 5M 09 F	6F	15	23,87	22,73	28,0	16	15	20
	16 5M 09 F	6F	16	25,46	24,32	28,0	16	15	20
	18 5M 09 F	6F	18	28,65	27,50	32,0	20	15	20
	20 5M 09 F	6F	20	31,83	30,69	36,0	23	15	23
	21 5M 09 F	6F	21	33,42	32,28	38,0	24	15	23
	22 5M 09 F	6F	22	35,01	33,87	39,0	26	15	23
	24 5M 09 F	6F	24	38,20	37,05	42,0	27	15	23
	26 5M 09 F	6F	26	41,38	40,24	44,0	30	15	23
	28 5M 09 F	6F	28	44,56	43,42	48,0	31	15	23
	30 5M 09 F	6F	30	47,75	46,60	51,0	35	15	23
	32 5M 09 F	6F	32	50,93	49,79	54,0	38	15	23
	36 5M 09 F	6F	36	57,30	56,15	60,0	38	15	23
	40 5M 09 F	6F	40	63,66	62,52	71,0	38	15	23
	44 5M 09	6W	44	70,03	68,89	-	38	15	26
	48 5M 09	6W	48	76,39	75,25	-	45	15	26
60 5M 09	6W	60	95,49	94,35	-	45	15	26	
72 5M 09	6W	72	114,59	113,45	-	45	15	26	
HTD 5M 15 (passo 5 mm) per cinghia di larghezza 15 mm HTD 5M 15 (5 mm pitch) for 15 mm width belt	12 5M 15 F	6F	12	19,09	17,95	23,0	12	21	26
	14 5M 15 F	6F	14	22,28	21,14	25,0	13	21	26
	15 5M 15 F	6F	15	23,87	22,73	28,0	16	21	26
	16 5M 15 F	6F	16	25,46	24,32	28,0	16	21	26
	18 5M 15 F	6F	18	28,65	27,50	32,0	20	21	26
	20 5M 15 F	6F	20	31,83	30,69	36,0	23	21	26
	21 5M 15 F	6F	21	33,42	32,28	38,0	24	21	26
	22 5M 15 F	6F	22	35,01	33,87	39,0	26	21	26
	24 5M 15 F	6F	24	38,20	37,05	42,0	27	21	28
	26 5M 15 F	6F	26	41,38	40,24	44,0	30	21	28
	28 5M 15 F	6F	28	44,56	43,42	48,0	31	21	28
	30 5M 15 F	6F	30	47,75	46,60	51,0	35	21	28
	32 5M 15 F	6F	32	50,93	49,79	54,0	38	21	28
	36 5M 15 F	6F	36	57,30	56,15	60,0	38	21	28
	40 5M 15 F	6F	40	63,66	62,52	71,0	38	21	28
	44 5M 15	6W	44	70,03	68,89	-	38	21	30
	48 5M 15	6W	48	76,39	75,25	-	40	21	30
60 5M 15	6W	60	95,49	94,35	-	50	21	30	

HTD 5M

Passo 5mm / 5mm Pitch

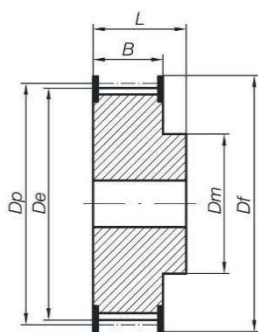

6F

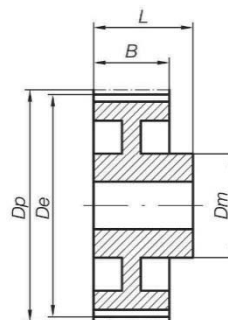

6W

Materiale: Alluminio e acciaio

Material: Aluminium & Steel

	Codice Code	Disegno Drawing	N° Denti Teeth	Dp	De	Df	Dm	B	L
	72 5M 15	6W	72	114,59	113,45	-	50	21	30
HTD 5M 25 (passo 5 mm) per cinghia di larghezza 25 mm HTD 5M 25 (5 mm pitch) for 25 mm width belt	12 5M 25 F	6F	12	19,09	17,95	23,0	12	31	36
	14 5M 25 F	6F	14	22,28	21,14	25,0	13	31	36
	15 5M 25 F	6F	15	23,87	22,73	28,0	16	31	36
	16 5M 25 F	6F	16	25,46	24,32	28,0	16	31	36
	18 5M 25 F	6F	18	28,65	27,50	32,0	20	31	36
	20 5M 25 F	6F	20	31,83	30,69	36,0	23	31	36
	21 5M 25 F	6F	21	33,42	32,28	38,0	24	31	38
	22 5M 25 F	6F	22	35,01	33,87	39,0	26	31	38
	24 5M 25 F	6F	24	38,20	37,05	42,0	27	31	38
	26 5M 25 F	6F	26	41,38	40,24	44,0	30	31	38
	28 5M 25 F	6F	28	44,56	43,42	48,0	31	31	38
	30 5M 25 F	6F	30	47,75	46,60	51,0	35	31	38
	32 5M 25 F	6F	32	50,93	49,79	54,0	38	31	38
	36 5M 25 F	6F	36	57,30	56,15	60,0	38	31	38
	40 5M 25 F	6F	40	63,66	62,52	71,0	38	31	38
	44 5M 25	6W	44	70,03	68,89	-	38	31	40
	48 5M 25	6W	48	76,39	75,25	-	40	31	40
60 5M 25	6W	60	95,49	94,35	-	50	31	40	
72 5M 25	6W	72	114,59	113,45	-	50	31	40	

Df e Dm possono variare senza preavviso / Df and Dm can vary without notice

Nelle forme costruttive gli scarichi di alleggerimento possono leggermente variare / During manufacturing, the lightening relief may vary slightly