

HTD 14M

Passo 14mm / 14mm Pitch

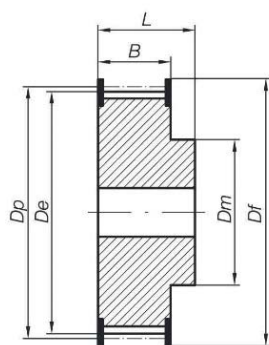

6F

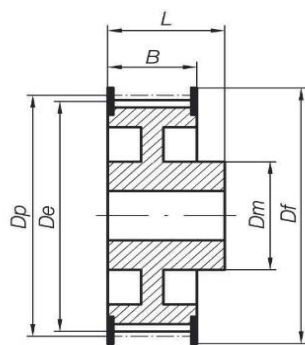

6WF

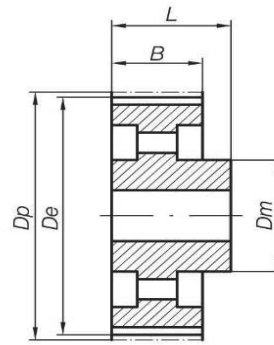

6A

Materiale: Acciaio e Ghisa

	Codice Code	Disegno Drawing	N° Denti Teeth	Dp	De	Df	Dm	B	L
HTD 14M 40 (passo 14 mm) per cinghia di larghezza 40 mm HTD 14M 40 (14 mm pitch) for 40 mm width belt	28 14M 40 F	6F	28	124,78	121,98	128,0	100	54	69
	29 14M 40 F	6F	29	129,23	126,44	138,0	100	54	69
	30 14M 40 F	6F	30	133,69	130,90	138,0	100	54	69
	32 14M 40 F	6F	32	142,60	139,81	154,0	100	54	69
	34 14M 40 F	6F	34	151,51	148,72	160,0	100	54	69
	36 14M 40 F	6F	36	160,43	157,68	168,0	100	54	69
	38 14M 40 F	6F	38	169,34	166,60	183,0	120	54	69
	40 14M 40 F	6F	40	178,25	175,49	188,0	120	54	69
	44 14M 40 F	6F	44	196,08	193,28	211,0	120	54	69
	48 14M 40 F	6WF	48	213,90	211,11	226,0	135	54	69
	56 14M 40 F	6WF	56	249,55	246,76	256,0	135	54	69
	64 14M 40 F	6WF	64	285,21	282,41	296,0	135	54	69
	72 14M 40	6A	72	320,86	318,06	-	135	54	69
	80 14M 40	6A	80	356,51	353,71	-	135	54	69
	90 14M 40	6A	90	401,07	398,28	-	135	54	69
	112 14M 40	6A	112	499,11	496,32	-	135	54	69
	144 14M 40	6A	144	641,71	638,92	-	135	54	69
168 14M 40	6A	168	748,66	745,87	-	135	54	69	
192 14M 40	6A	192	855,62	852,82	-	135	54	69	
216 14M 40	6A	216	962,57	959,76	-	150	54	69	
HTD 14M 55 per cinghia da 55 mm HTD 14M 55 for 55 mm width belt	28 14M 55 F	6F	28	124,78	121,98	128,0	100	70	85
	29 14M 55 F	6F	29	129,23	126,44	138,0	100	70	85
	30 14M 55 F	6F	30	133,69	130,90	138,0	100	70	85
	32 14M 55 F	6F	32	142,60	139,81	154,0	100	70	85
	34 14M 55 F	6F	34	151,51	148,72	160,0	100	70	85
	36 14M 55 F	6F	36	160,43	157,68	168,0	100	70	85
	38 14M 55 F	6F	38	169,34	166,60	183,0	120	70	85

Pullegge Dentate Passo HTD

HTD Pitch Timing Pulleys

HTD 14M

Passo 14mm / 14mm Pitch

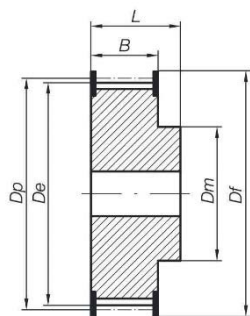

6F

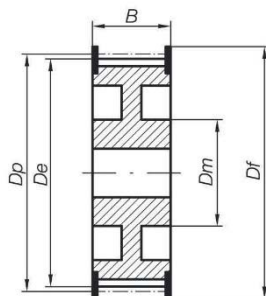

10WF

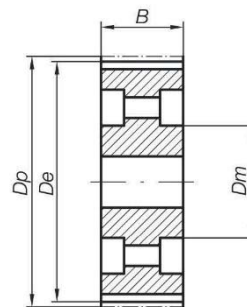

10A

Materiale: Acciaio e Ghisa

Material: Steel & Cast Iron

	Codice Code	Disegno Drawing	N° Denti Teeth	Dp	De	Df	Dm	B	L
HTD 14M 55 (passo 14 mm) per cinghia di larghezza 55 mm HTD 14M 55 (14 mm pitch) for 55 mm width belt	40 14M 55 F	6F	40	178,25	175,49	188,0	120	70	85
	44 14M 55 F	6F	44	196,08	193,28	211,0	120	70	85
	48 14M 55 F	10WF	48	213,90	211,11	226,0	135	70	70
	56 14M 55 F	10WF	56	249,55	246,76	256,0	135	70	70
	64 14M 55 F	10WF	64	285,21	282,41	296,0	135	70	70
	72 14M 55	10A	72	320,86	318,06	-	135	70	70
	80 14M 55	10A	80	356,51	353,71	-	135	70	70
	90 14M 55	10A	90	401,07	398,28	-	135	70	70
	112 14M 55	10A	112	499,11	496,32	-	135	70	70
	144 14M 55	10A	144	641,71	638,92	-	135	70	70
	168 14M 55	10A	168	748,66	745,87	-	135	70	70
	192 14M 55	10A	192	855,62	852,82	-	135	70	70
	216 14M 55	10A	216	962,57	959,76	-	150	70	70
HTD 14M 85 (passo 14 mm) per cinghia di larghezza 85 mm HTD 14M 85 (14 mm pitch) for 85 mm width belt	28 14M 85 F	6F	28	124,78	121,98	128,0	100	102	117
	29 14M 85 F	6F	29	129,23	126,44	138,0	100	102	117
	30 14M 85 F	6F	30	133,69	130,90	138,0	100	102	117
	32 14M 85 F	6F	32	142,60	139,81	154,0	100	102	117
	34 14M 85 F	6F	34	151,51	148,72	160,0	100	102	117
	36 14M 85 F	6F	36	160,43	157,68	168,0	100	102	117
	38 14M 85 F	6F	38	169,34	166,60	183,0	120	102	117
	40 14M 85 F	6F	40	178,25	175,49	188,0	135	102	117
	44 14M 85 F	6F	44	196,08	193,28	211,0	135	102	117
	48 14M 85 F	6F	48	213,90	211,11	226,0	150	102	117
	56 14M 85 F	10WF	56	249,55	246,76	256,0	150	102	102
	64 14M 85 F	10WF	64	285,21	282,41	296,0	150	102	102
	72 14M 85	10A	72	320,86	318,06	-	150	102	102
	80 14M 85	10A	80	356,51	353,71	-	150	102	102
	90 14M 85	10A	90	401,07	398,28	-	150	102	102
	112 14M 85	10A	112	499,11	496,32	-	150	102	102
	144 14M 85	10A	144	641,71	638,92	-	150	102	102
	168 14M 85	10A	168	748,66	745,87	-	150	102	102
	192 14M 85	10A	192	855,62	852,82	-	165	102	102
	216 14M 85	10A	216	962,57	959,76	-	165	102	102
	28 14M 115 F	6F	28	124,78	121,98	128,0	100	133	148
29 14M 115 F	6F	29	129,23	126,44	138,0	100	133	148	
30 14M 115 F	6F	30	133,69	130,90	138,0	100	133	148	
32 14M 115 F	6F	32	142,60	139,81	154,0	100	133	148	

HTD 14M

Passo 14mm / 14mm Pitch

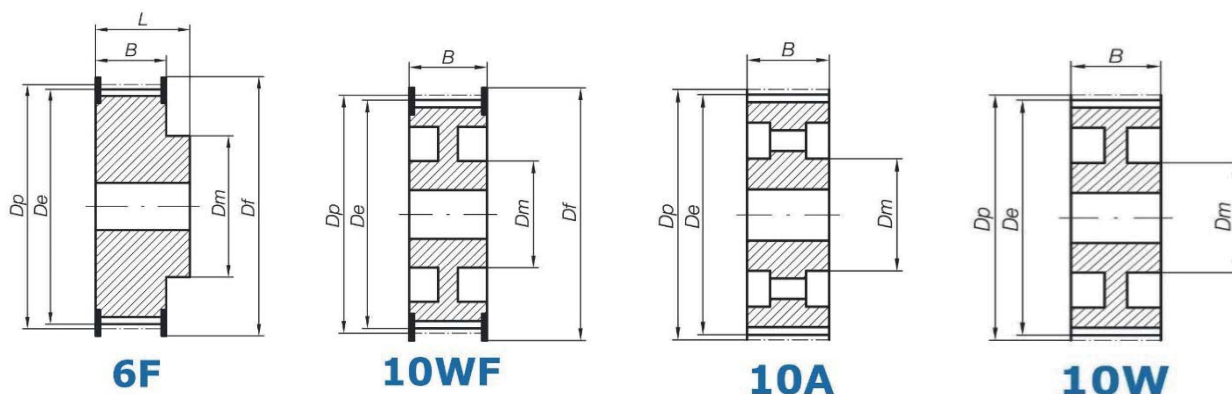

Materiale: Acciaio e Ghisa

Material: Steel & Cast Iron

	Codice Code	Disegno Drawing	N° Denti Teeth	Dp	De	Df	Dm	B	L
HTD 14M 115 (passo 14 mm) HTD 14M 115 (14 mm pitch) for 115 mm width belt	34 14M 115 F	6F	34	151,51	148,72	160,0	100	133	148
	36 14M 115 F	6F	36	160,43	157,68	168,0	120	133	148
	38 14M 115 F	6F	38	169,34	166,60	183,0	120	133	148
	40 14M 115 F	6F	40	178,25	175,49	188,0	135	133	148
	44 14M 115 F	6F	44	196,08	193,28	211,0	140	133	148
	48 14M 115 F	6F	48	213,90	211,11	226,0	150	133	148
	56 14M 115 F	6F	56	249,55	246,76	256,0	150	133	148
	64 14M 115 F	10WF	64	285,21	282,41	296,0	150	133	133
	72 14M 115	10A	72	320,86	318,06	-	150	133	133
	80 14M 115	10A	80	356,51	353,71	-	150	133	133
	90 14M 115	10A	90	401,07	398,28	-	150	133	133
	112 14M 115	10A	112	499,11	496,32	-	150	133	133
	144 14M 115	10A	144	641,71	638,92	-	165	133	133
	168 14M 115	10A	168	748,66	745,87	-	165	133	133
	192 14M 115	10A	192	855,62	852,82	-	165	133	133
216 14M 115	10A	216	962,57	959,76	-	165	133	133	
HTD 14M 170 (passo 14 mm) HTD 14M 170 (14 mm pitch) for 170 mm width belt	28 14M 170 F	6F	28	124,78	121,98	128,0	100	187	202
	29 14M 170 F	6F	29	129,23	126,44	138,0	100	187	202
	30 14M 170 F	6F	30	133,69	130,90	138,0	100	187	202
	32 14M 170 F	6F	32	142,60	139,81	154,0	100	187	202
	34 14M 170 F	6F	34	151,51	148,72	160,0	100	187	202
	36 14M 170 F	6F	36	160,43	157,68	168,0	120	187	202
	38 14M 170 F	6F	38	169,34	166,60	183,0	135	187	202
	40 14M 170 F	6F	40	178,25	175,49	188,0	140	187	202
	44 14M 170 F	6F	44	196,08	193,28	211,0	160	187	202
	48 14M 170 F	6F	48	213,90	211,11	226,0	160	187	202
	56 14M 170 F	6F	56	249,55	246,76	256,0	160	187	202
	64 14M 170 F	6F	64	285,21	282,41	296,0	180	187	202
	72 14M 170	10W	72	320,86	318,06	-	180	187	187
	80 14M 170	10W	80	356,51	353,71	-	180	187	187
	90 14M 170	10A	90	401,07	398,28	-	180	187	187
	112 14M 170	10A	112	499,11	496,32	-	200	187	187
	144 14M 170	10A	144	641,71	638,92	-	220	187	187
	168 14M 170	10A	168	748,66	745,87	-	220	187	187
	192 14M 170	10A	192	855,62	852,82	-	220	187	187
216 14M 170	10A	216	962,57	959,76	-	220	187	187	

Df e Dm possono variare senza preavviso / Df and Dm can vary without notice