

T5

Passo 5mm / 5mm Pitch

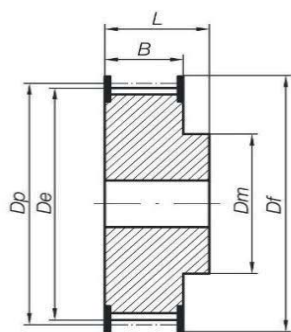

6F

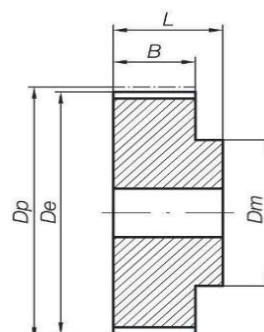

6

Materiale: Alluminio

Material: Aluminium

	Codice Code	Disegno Drawing	N° Denti Teeth	Dp	De	Df	Dm	B	L
T5 per cinghia di larghezza 10 mm T5 for 10 mm width belt	21T5/10-2	6F	10	15,92	15,09	19,5	8	15	21
	21T5/12-2	6F	12	19,10	18,27	23,0	11	15	21
	21T5/14-2	6F	14	22,28	21,45	25,0	13	15	21
	21T5/15-2	6F	15	23,87	23,04	28,0	16	15	21
	21T5/16-2	6F	16	25,46	24,64	32,0	18	15	21
	21T5/18-2	6F	18	28,65	27,82	32,0	20	15	21
	21T5/19-2	6F	19	30,24	29,41	36,0	22	15	21
	21T5/20-2	6F	20	31,83	31,00	36,0	23	15	21
	21T5/22-2	6F	22	35,01	34,19	38,0	24	15	21
	21T5/24-2	6F	24	38,20	37,37	42,0	26	15	21
	21T5/25-2	6F	25	39,79	38,96	44,0	26	15	21
	21T5/26-2	6F	26	41,38	40,55	44,0	26	15	21
	21T5/27-2	6F	27	42,97	42,14	48,0	30	15	21
	21T5/28-2	6F	28	44,56	43,73	48,0	32	15	21
	21T5/30-2	6F	30	47,75	46,92	51,0	34	15	21
	21T5/32-2	6F	32	50,93	50,10	54,0	38	15	21
	21T5/36-2	6F	36	57,30	56,47	64,0	38	15	21
	21T5/40-2	6F	40	63,66	62,83	66,5	40	15	21
	21T5/42-2	6F	42	66,85	66,02	70,0	40	15	21
21T5/44-0	6	44	70,03	69,20	-	45	15	21	
21T5/48-0	6	48	76,39	75,57	-	50	15	21	
21T5/60-0	6	60	95,49	94,67	-	65	15	21	
T5 per cinghia di larghezza 16 mm T5 for 16 mm width belt	27T5/10-2	6F	10	15,92	15,09	19,5	8	21	27
	27T5/12-2	6F	12	19,10	18,27	23,0	11	21	27
	27T5/14-2	6F	14	22,28	21,45	25,0	13	21	27
	27T5/15-2	6F	15	23,87	23,04	28,0	16	21	27
	27T5/16-2	6F	16	25,46	24,64	32,0	18	21	27
	27T5/18-2	6F	18	28,65	27,82	32,0	20	21	27
	27T5/19-2	6F	19	30,24	29,41	36,0	20	21	27
	27T5/20-2	6F	20	31,83	31,00	36,0	23	21	27
	27T5/22-2	6F	22	35,01	34,19	38,0	24	21	27
	27T5/24-2	6F	24	38,20	37,37	42,0	26	21	27
	27T5/25-2	6F	25	39,79	38,96	44,0	26	21	27
	27T5/26-2	6F	26	41,38	40,55	44,0	26	21	27
	27T5/27-2	6F	27	42,97	42,14	48,0	30	21	27
27T5/28-2	6F	28	44,56	43,73	48,0	32	21	27	
27T5/30-2	6F	30	47,75	46,92	51,0	34	21	27	