

**AT5**

**Passo 5mm / 5mm Pitch**

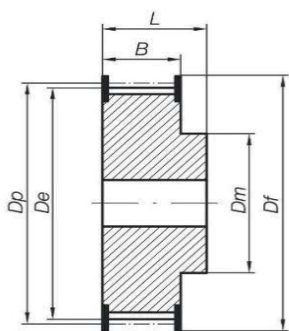

**6F**

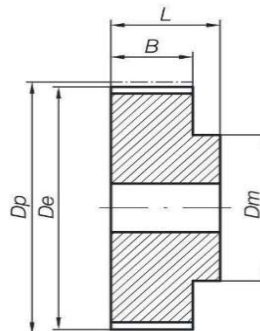

**6**

Materiale: Alluminio

Material: Aluminium

	Codice Code	Disegno Drawing	N° Denti Teeth	Dp	De	Df	Dm	B	L
AT5 per cinghia di larghezza 10 mm AT5 for 10 mm width belt	21AT5/12-2	6F	12	19,10	17,87	23,0	11	15	21
	21AT5/14-2	6F	14	22,28	21,05	25,0	14	15	21
	21AT5/15-2	6F	15	23,87	22,64	28,0	16	15	21
	21AT5/16-2	6F	16	25,46	24,24	32,0	18	15	21
	21AT5/18-2	6F	18	28,65	27,42	32,0	20	15	21
	21AT5/19-2	6F	19	30,24	29,01	36,0	22	15	21
	21AT5/20-2	6F	20	31,83	30,60	36,0	23	15	21
	21AT5/22-2	6F	22	35,01	33,79	38,0	24	15	21
	21AT5/24-2	6F	24	38,20	36,97	42,0	26	15	21
	21AT5/25-2	6F	25	39,79	38,56	44,0	26	15	21
	21AT5/26-2	6F	26	41,38	40,15	44,0	26	15	21
	21AT5/27-2	6F	27	42,97	41,74	48,0	30	15	21
	21AT5/28-2	6F	28	44,56	43,33	48,0	32	15	21
	21AT5/30-2	6F	30	47,75	46,52	51,0	34	15	21
	21AT5/32-2	6F	32	50,93	49,70	54,0	38	15	21
	21AT5/36-2	6F	36	57,30	56,07	64,0	38	15	21
	21AT5/40-2	6F	40	63,66	62,43	67,0	40	15	21
	21AT5/42-2	6F	42	66,85	65,62	70,0	40	15	21
21AT5/44-0	6	44	70,03	68,80	-	45	15	21	
21AT5/48-0	6	48	76,39	75,17	-	50	15	21	
21AT5/60-0	6	60	95,49	94,27	-	65	15	21	
AT5 per cinghia di larghezza 16 mm AT5 for 16 mm width belt	27AT5/12-2	6F	12	19,10	17,87	23,0	11	21	27
	27AT5/14-2	6F	14	22,28	21,05	25,0	14	21	27
	27AT5/15-2	6F	15	23,87	22,64	28,0	16	21	27
	27AT5/16-2	6F	16	25,46	24,24	32,0	18	21	27
	27AT5/18-2	6F	18	28,65	27,42	32,0	20	21	27
	27AT5/19-2	6F	19	30,24	29,01	36,0	22	21	27
	27AT5/20-2	6F	20	31,83	30,60	36,0	23	21	27
	27AT5/22-2	6F	22	35,01	33,79	38,0	24	21	27
	27AT5/24-2	6F	24	38,20	36,97	42,0	26	21	27
	27AT5/25-2	6F	25	39,79	38,56	44,0	26	21	27
	27AT5/26-2	6F	26	41,38	40,15	44,0	26	21	27
	27AT5/27-2	6F	27	42,97	41,74	48,0	30	21	27
	27AT5/28-2	6F	28	44,56	43,33	48,0	32	21	27
	27AT5/30-2	6F	30	47,75	46,52	51,0	34	21	27
27AT5/32-2	6F	32	50,93	49,70	54,0	36	21	27	
27AT5/36-2	6F	36	57,30	56,07	64,0	38	21	27	

# Pulegge Dentate Passo Metrico

## Metric Pitch Timing Pulleys

### AT5

### Passo 5mm / 5mm Pitch

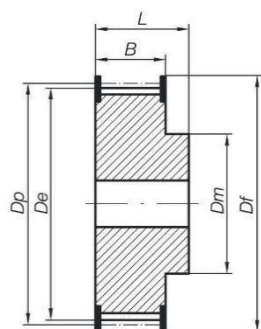

**6F**

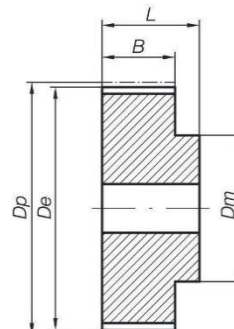

**6**

Materiale: Alluminio

Material: Aluminium

	Codice Code	Disegno Drawing	N° Denti Teeth	Dp	De	Df	Dm	B	L
	27AT5/40-2	6F	40	63,66	62,43	67,0	40	21	27
	27AT5/42-2	6F	42	66,85	65,62	70,0	40	21	27
	27AT5/44-0	6	44	70,03	68,80	-	45	21	27
	27AT5/48-0	6	48	76,39	75,17	-	50	21	27
	27AT5/60-0	6	60	95,49	94,27	-	65	21	27
AT5 per cinghia di larghezza 25 mm AT5 for 25 mm width belt	36AT5/12-2	6F	12	19,10	17,87	23,0	11	30	36
	36AT5/14-2	6F	14	22,28	21,05	25,0	14	30	36
	36AT5/15-2	6F	15	23,87	22,64	28,0	16	30	36
	36AT5/16-2	6F	16	25,46	24,24	32,0	18	30	36
	36AT5/18-2	6F	18	28,65	27,42	32,0	20	30	36
	36AT5/19-2	6F	19	30,24	29,01	36,0	22	30	36
	36AT5/20-2	6F	20	31,83	30,60	36,0	23	30	36
	36AT5/22-2	6F	22	35,01	33,79	38,0	24	30	36
	36AT5/24-2	6F	24	38,20	36,97	42,0	26	30	36
	36AT5/25-2	6F	25	39,79	38,56	44,0	26	30	36
	36AT5/26-2	6F	26	41,38	40,15	44,0	26	30	36
	36AT5/27-2	6F	27	42,97	41,74	48,0	30	30	36
	36AT5/28-2	6F	28	44,56	43,33	48,0	32	30	36
	36AT5/30-2	6F	30	47,75	46,52	51,0	34	30	36
	36AT5/32-2	6F	32	50,93	49,70	54,0	36	30	36
	36AT5/36-2	6F	36	57,30	56,07	64,0	38	30	36
	36AT5/40-2	6F	40	63,66	62,43	67,0	40	30	36
	36AT5/42-2	6F	42	66,85	65,62	70,0	40	30	36
36AT5/44-0	6	44	70,03	68,80	-	45	30	36	
36AT5/48-0	6	48	76,39	75,17	-	50	30	36	
36AT5/60-0	6	60	95,49	94,27	-	65	30	36	

Df e Dm possono variare senza preavviso | Df and Dm can vary without notice

Nelle forme costruttive gli scarichi di alleggerimento possono leggermente variare | During manufacturing, the lightening relief may vary slightly