

AT3

Passo 3mm / 3mm Pitch

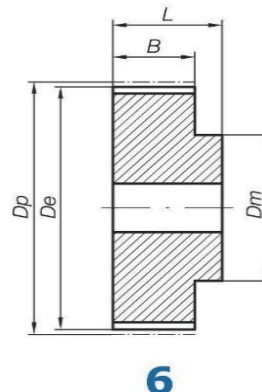
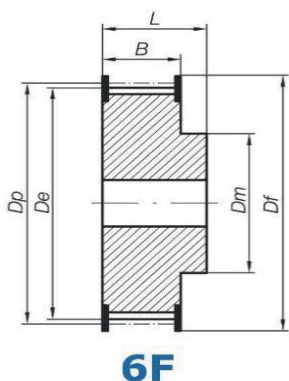

Materiale: Alluminio

Material: Aluminium

	Codice Code	Disegno Drawing	N° Denti Teeth	Dp	De	Df	Dm	B	L
AT3 per cinghia di larghezza 10 mm AT3 for 10 mm width belt	21AT3/20-2	6F	20	19,10	18,69	24,0	14	15	21
	21AT3/22-2	6F	22	21,01	20,60	26,0	14	15	21
	21AT3/24-2	6F	24	22,92	22,51	28,0	14	15	21
	21AT3/25-2	6F	25	23,87	23,46	30,0	16	15	21
	21AT3/26-2	6F	26	24,83	24,42	30,0	16	15	21
	21AT3/27-2	6F	27	25,78	25,37	30,0	16	15	21
	21AT3/28-2	6F	28	26,74	26,33	32,0	16	15	21
	21AT3/30-2	6F	30	28,65	28,24	34,0	20	15	21
	21AT3/32-2	6F	32	30,56	30,15	36,0	20	15	21
	21AT3/34-2	6F	34	32,47	32,06	37,0	20	15	21
	21AT3/36-2	6F	36	34,38	33,97	40,0	22	15	21
	21AT3/38-2	6F	38	36,29	35,88	42,0	22	15	21
	21AT3/40-2	6F	40	38,20	37,79	43,0	26	15	21
	21AT3/42-2	6F	42	40,11	39,70	45,0	26	15	21
	21AT3/44-2	6F	44	42,02	41,61	47,0	30	15	21
	21AT3/46-2	6F	46	43,93	43,52	50,0	30	15	21
	AT3 16 (passo 3 mm) per cinghia di larghezza 16 mm AT3 16 (3 mm pitch) for 16 mm width belt	28AT3/20-2	6F	20	19,10	18,69	24,0	14	22
28AT3/22-2		6F	22	21,01	20,60	26,0	14	22	28
28AT3/24-2		6F	24	22,92	22,51	28,0	14	22	28
28AT3/25-2		6F	25	23,87	23,46	30,0	16	22	28
28AT3/26-2		6F	26	24,83	24,42	30,0	16	22	28
28AT3/27-2		6F	27	25,78	25,37	30,0	16	22	28
28AT3/28-2		6F	28	26,74	26,33	32,0	16	22	28
28AT3/30-2		6F	30	28,65	28,24	34,0	20	22	28
28AT3/32-2		6F	32	30,56	30,15	36,0	20	22	28
28AT3/34-2		6F	34	32,47	32,06	37,0	20	22	28
28AT3/36-2		6F	36	34,38	33,97	40,0	22	22	28
28AT3/38-2		6F	38	36,29	35,88	42,0	22	22	28
28AT3/40-2		6F	40	38,20	37,79	43,0	26	22	28
28AT3/42-2		6F	42	40,11	39,70	45,0	26	22	28
28AT3/44-2		6F	44	42,02	41,61	47,0	30	22	28
28AT3/46-2		6F	46	43,93	43,52	50,0	30	22	28

Pulegge Dentate Passo Metrico

Metric Pitch Timing Pulleys

AT3

Passo 3mm / 3mm Pitch

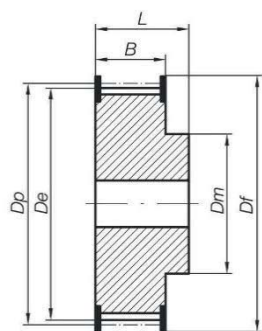

6F

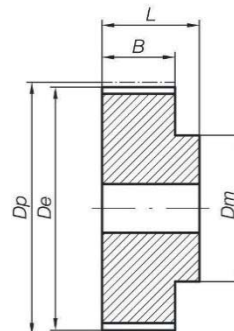

6

Materiale: Alluminio

Material: Aluminium

	Codice Code	Disegno Drawing	N° Denti Teeth	Dp	De	Df	Dm	B	L
	28AT3/48-2	6F	48	45,84	45,43	52,0	34	22	28
	28AT3/52-0	6	52	49,66	49,25	-	34	22	28
	28AT3/56-0	6	56	53,48	53,07	-	34	22	28
	28AT3/60-0	6	60	57,30	56,89	-	38	22	28
	28AT3/64-0	6	64	61,12	60,71	-	38	22	28
AT3 per cinghia di larghezza 25 mm AT3 for 25 mm width belt	38AT3/20-2	6F	20	19,10	18,69	24,0	14	32	38
	38AT3/22-2	6F	22	21,01	20,60	26,0	14	32	38
	38AT3/24-2	6F	24	22,92	22,51	28,0	14	32	38
	38AT3/25-2	6F	25	23,87	23,46	30,0	16	32	38
	38AT3/26-2	6F	26	24,83	24,42	30,0	16	32	38
	38AT3/27-2	6F	27	25,78	25,37	30,0	16	32	38
	38AT3/28-2	6F	28	26,74	26,33	32,0	16	32	38
	38AT3/30-2	6F	30	28,65	28,24	34,0	20	32	38
	38AT3/32-2	6F	32	30,56	30,15	36,0	20	32	38
	38AT3/34-2	6F	34	32,47	32,06	37,0	20	32	38
	38AT3/36-2	6F	36	34,38	33,97	40,0	22	32	38
	38AT3/38-2	6F	38	36,29	35,88	42,0	22	32	38
	38AT3/40-2	6F	40	38,20	37,79	43,0	26	32	38
	38AT3/42-2	6F	42	40,11	39,70	45,0	26	32	38
	38AT3/44-2	6F	44	42,02	41,61	47,0	30	32	38
	38AT3/46-2	6F	46	43,93	43,52	50,0	30	32	38
	38AT3/48-2	6F	48	45,84	45,43	52,0	34	32	38
		38AT3/52-0	6	52	49,66	49,25	-	34	32
	38AT3/56-0	6	56	53,48	53,07	-	34	32	38
	38AT3/60-0	6	60	57,30	56,89	-	38	32	38
	38AT3/64-0	6	64	61,12	60,71	-	38	32	38

Df e Dm possono variare senza preavviso | Df and Dm can vary without notice

Nelle forme costruttive gli scarichi di alleggerimento possono leggermente variare | During manufacturing, the lightening relief may vary slightly