

AT20

Passo 20mm / 20mm Pitch

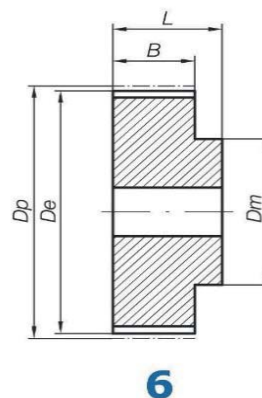
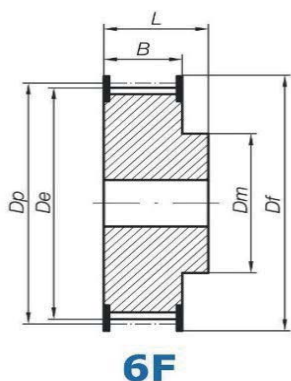

Materiale: Alluminio Material: Aluminium

	Codice Code	Disegno Drawing	N° Denti Teeth	Dp	De	Df	Dm	B	L
AT20 per cinghia di larghezza 32 mm AT20 for 32 mm width belt	53AT20/18-2	6F	18	114,59	111,73	119,0	80	42	53
	53AT20/20-2	6F	20	127,32	124,47	138,0	90	42	53
	53AT20/22-2	6F	22	140,06	137,20	145,0	90	42	53
	53AT20/24-2	6F	24	152,79	149,93	162,0	95	42	53
	53AT20/25-2	6F	25	159,15	156,30	168,0	95	42	53
	53AT20/30-2	6F	30	190,99	188,13	200,0	110	42	53
	53AT20/32-0	6	32	203,72	200,86	-	110	42	53
	53AT20/36-0	6	36	229,18	226,33	-	110	42	53
	53AT20/40-0	6	40	254,65	251,80	-	110	42	53
	53AT20/48-0	6	48	305,58	302,73	-	130	42	53
	53AT20/60-0	6	60	381,97	379,12	-	130	42	53
AT20 per cinghia di larghezza 50 mm AT20 for 50 mm width belt	71AT20/18-2	6F	18	114,59	111,73	119,0	80	60	71
	71AT20/20-2	6F	20	127,32	124,47	138,0	90	60	71
	71AT20/22-2	6F	22	140,06	137,20	145,0	90	60	71
	71AT20/24-2	6F	24	152,79	149,93	162,0	95	60	71
	71AT20/25-2	6F	25	159,15	156,30	168,0	95	60	71
	71AT20/30-2	6F	30	190,99	188,13	200,0	110	60	71
	71AT20/32-0	6	32	203,72	200,86	-	110	60	71
	71AT20/36-0	6	36	229,18	226,33	-	110	60	71
	71AT20/40-0	6	40	254,65	251,80	-	110	60	71
	71AT20/48-0	6	48	305,58	302,73	-	130	60	71
	71AT20/60-0	6	60	381,97	379,12	-	130	60	71
AT20 per cinghia di larghezza 75 mm AT20 for 75 mm width belt	106AT20/18-2	6F	18	114,59	111,73	119,0	80	85	106
	106AT20/20-2	6F	20	127,32	124,47	138,0	90	85	106
	106AT20/22-2	6F	22	140,06	137,20	145,0	90	85	106
	106AT20/24-2	6F	24	152,79	149,93	162,0	95	85	106
	106AT20/25-2	6F	25	159,15	156,30	168,0	95	85	106
	106AT20/30-2	6F	30	190,99	188,13	200,0	110	85	106
	106AT20/32-0	6	32	203,72	200,86	-	110	85	106
	106AT20/36-0	6	36	229,18	226,33	-	110	85	106
	106AT20/40-0	6	40	254,65	251,80	-	110	85	106
	106AT20/48-0	6	48	305,58	302,73	-	130	85	106
	106AT20/60-0	6	60	381,97	379,12	-	130	85	106
123AT20/18-2	123AT20/18-2	6F	18	114,59	111,73	119,0	80	110	123
	123AT20/20-2	6F	20	127,32	124,47	138,0	90	110	123
	123AT20/22-2	6F	22	140,06	137,20	145,0	90	110	123
	123AT20/24-2	6F	24	152,79	149,93	162,0	95	110	123

Pulegge Dentate Passo Metrico

Metric Pitch Timing Pulleys

AT20

Passo 20mm / 20mm Pitch

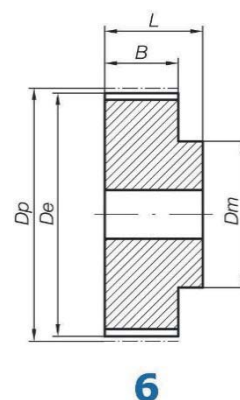
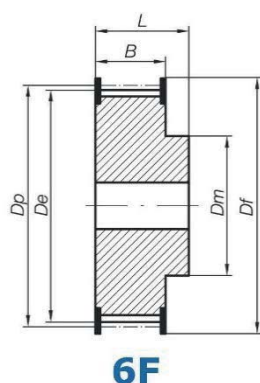

Materiale: Alluminio

Material: Aluminium

AT20 per cinghia larg. 100 mm AT20 for 100 mm width belt	Codice Code	Disegno Drawing	N° Denti Teeth	Dp	De	Df	Dm	B	L
	123AT20/25-2	6F	25	159,15	156,30	168,0	95	110	123
	123AT20/30-2	6F	30	190,99	188,13	200,0	110	110	123
	123AT20/32-0	6	32	203,72	200,86	-	110	110	123
	123AT20/36-0	6	36	229,18	226,33	-	110	110	123
	123AT20/40-0	6	40	254,65	251,80	-	110	110	123
	123AT20/48-0	6	48	305,58	302,73	-	130	110	123
	123AT20/60-0	6	60	381,97	379,12	-	130	110	123

Df e Dm possono variare senza preavviso | Df and Dm can vary without notice

Nelle forme costruttive gli scarichi di alleggerimento possono leggermente variare | During manufacturing, the lightening relief may vary slightly