

**AT10**

**Passo 10mm / 10mm Pitch**

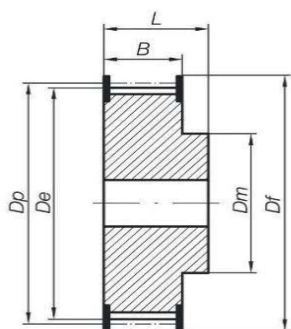

**6F**

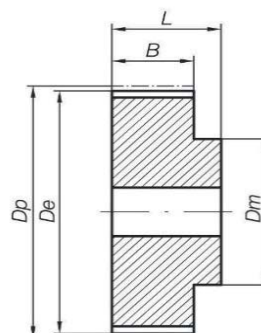

**6**

Materiale: Alluminio

Material: Aluminium

	Codice Code	Disegno Drawing	N° Denti Teeth	Dp	De	Df	Dm	B	L
AT10 per cinghia di larghezza 16 mm AT10 for 16 mm width belt	31AT10/15-2	6F	15	47,75	45,90	51,0	32	21	31
	31AT10/16-2	6F	16	50,93	49,08	54,0	35	21	31
	31AT10/18-2	6F	18	57,30	55,45	60,0	40	21	31
	31AT10/19-2	6F	19	60,48	58,63	66,0	44	21	31
	31AT10/20-2	6F	20	63,66	61,81	66,0	46	21	31
	31AT10/22-2	6F	22	70,03	68,18	75,0	52	21	31
	31AT10/24-2	6F	24	76,39	74,55	83,0	58	21	31
	31AT10/25-2	6F	25	79,58	77,73	83,0	60	21	31
	31AT10/26-2	6F	26	82,76	80,91	87,0	60	21	31
	31AT10/27-2	6F	27	85,94	84,10	91,0	60	21	31
	31AT10/28-2	6F	28	89,13	87,28	93,0	60	21	31
	31AT10/30-2	6F	30	95,49	93,65	97,0	60	21	31
	31AT10/32-2	6F	32	101,86	100,01	106,0	65	21	31
	31AT10/36-2	6F	36	114,59	112,74	119,0	70	21	31
	31AT10/40-2	6F	40	127,32	125,48	131,0	80	21	31
	31AT10/44-0	6	44	140,06	138,21	-	88	21	31
31AT10/48-0	6	48	152,79	150,94	-	95	21	31	
31AT10/60-0	6	60	190,99	189,14	-	110	21	31	
AT10 per cinghia di larghezza 25 mm AT10 for 25 mm width belt	40AT10/15-2	6F	15	47,75	45,90	45,9	31	30	40
	40AT10/16-2	6F	16	50,93	49,08	49,1	35	30	40
	40AT10/18-2	6F	18	57,30	55,45	55,5	40	30	40
	40AT10/19-2	6F	19	60,48	58,63	58,6	44	30	40
	40AT10/20-2	6F	20	63,66	61,81	61,8	46	30	40
	40AT10/22-2	6F	22	70,03	68,18	68,2	52	30	40
	40AT10/24-2	6F	24	76,39	74,55	74,6	58	30	40
	40AT10/25-2	6F	25	79,58	77,73	77,7	60	30	40
	40AT10/26-2	6F	26	82,76	80,91	80,9	60	30	40
	40AT10/27-2	6F	27	85,94	84,10	84,1	60	30	40
	40AT10/28-2	6F	28	89,13	87,28	87,3	60	30	40
	40AT10/30-2	6F	30	95,49	93,65	93,7	60	30	40
	40AT10/32-2	6F	32	101,86	100,01	100,0	65	30	40
	40AT10/36-2	6F	36	114,59	112,74	112,7	70	30	40
	40AT10/40-2	6F	40	127,32	125,48	125,5	80	30	40
	40AT10/44-0	6	44	140,06	138,21	138,2	88	30	40
40AT10/48-0	6	48	152,79	150,94	150,9	95	30	40	
40AT10/60-0	6	60	190,99	189,14	189,1	110	30	40	

# Pulleye Dentate Passo Metrico

## Metric Pitch Timing Pulleys

### AT10

### Passo 10mm / 10mm Pitch

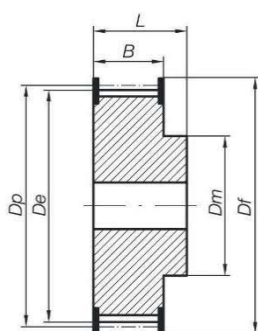

**6F**

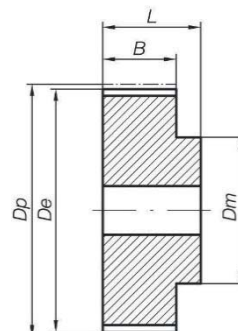

**6**

Materiale: Alluminio

Material: Aluminium

	Codice Code	Disegno Drawing	N° Denti Teeth	Dp	De	Df	Dm	B	L
AT10 per cinghia di larghezza 32 mm AT10 for 32 mm width belt	47AT10/18-2	6F	18	57,30	55,45	60,0	40	37	47
	47AT10/19-2	6F	19	60,48	58,63	66,0	44	37	47
	47AT10/20-2	6F	20	63,66	61,81	66,0	46	37	47
	47AT10/22-2	6F	22	70,03	68,18	75,0	52	37	47
	47AT10/24-2	6F	24	76,39	74,55	83,0	58	37	47
	47AT10/25-2	6F	25	79,58	77,73	83,0	60	37	47
	47AT10/26-2	6F	26	82,76	80,91	87,0	60	37	47
	47AT10/27-2	6F	27	85,94	84,10	91,0	60	37	47
	47AT10/28-2	6F	28	89,13	87,28	93,0	60	37	47
	47AT10/30-2	6F	30	95,49	93,65	97,0	60	37	47
	47AT10/32-2	6F	32	101,86	100,01	106,0	65	37	47
	47AT10/36-2	6F	36	114,59	112,74	119,0	70	37	47
	47AT10/40-2	6F	40	127,32	125,48	131,0	80	37	47
	47AT10/44-0	6	44	140,06	138,21	-	88	37	47
	47AT10/48-0	6	48	152,79	150,94	-	95	37	47
47AT10/60-0	6	60	190,99	189,14	-	110	37	47	
AT10 per cinghia di larghezza 50 mm AT10 for 50 mm width belt	66AT10/18-2	6F	18	57,30	55,45	60,0	40	56	66
	66AT10/19-2	6F	19	60,48	58,63	66,0	44	56	66
	66AT10/20-2	6F	20	63,66	61,81	66,0	46	56	66
	66AT10/22-2	6F	22	70,03	68,18	75,0	52	56	66
	66AT10/24-2	6F	24	76,39	74,55	83,0	58	56	66
	66AT10/25-2	6F	25	79,58	77,73	83,0	60	56	66
	66AT10/26-2	6F	26	82,76	80,91	87,0	60	56	66
	66AT10/27-2	6F	27	85,94	84,10	91,0	60	56	66
	66AT10/28-2	6F	28	89,13	87,28	93,0	60	56	66
	66AT10/30-2	6F	30	95,49	93,65	97,0	60	56	66
	66AT10/32-2	6F	32	101,86	100,01	106,0	65	56	66
	66AT10/36-2	6F	36	114,59	112,74	119,0	70	56	66
	66AT10/40-2	6F	40	127,32	125,48	131,0	80	56	66
	66AT10/44-0	6	44	140,06	138,21	-	88	56	66
	66AT10/48-0	6	48	152,79	150,94	-	95	56	66
66AT10/60-0	6	60	190,99	189,14	-	110	56	66	

Df e Dm possono variare senza preavviso / Df and Dm can vary without notice

Nelle forme costruttive gli scarichi di alleggerimento possono leggermente variare / During manufacturing, the lightening relief may vary slightly