

Design Data	
Commutation	Brushed
Direction of rotation	Bi-directional
Bearing type	A:Ball - B:Ball

Performance data		
Rated voltage [V]	$U_N$	24
Nominal torque [Nm]	$M_N$	0.08
No-load speed [ $\text{min}^{-1}$ ]	$n_0$	2,800.0
Nominal power [W]	$P_N$	17.6
Nominal current [A]	$I_N$	1.0
Nominal force [kN]	$F_N$	0.00
Duty cycle	s3	

Sensor data	
Pulses	0
Output channels	0

Other data	
Gear ratio	
Gear wheel material	
Suppression components	7.5 $\mu$ H, 47nF
Enclosure class	IP 30
Weight [kg]	0.550

Remarks:

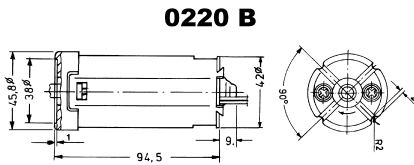

### Motor picture



### Characteristic curves

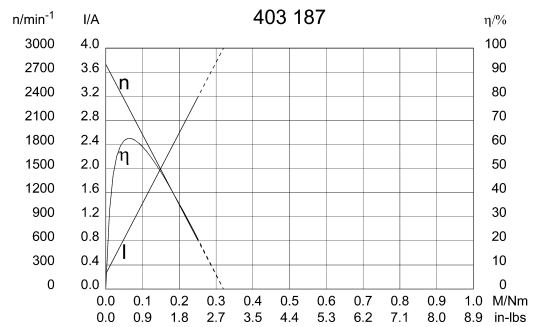

### Output shaft drawing (W), Wiring diagrams (S) and Connector layout (K)

